



Pembury Road, London, E5

BUTLER & STAG



A recently updated one bedroom flat set on the fourth floor of this purpose built block with lift access. Set in a convenient location close to transport links, shops, eateries, open green spaces and amenities.



- One Bedroom
- Part Furnished
- Lift Access
- Great Transport Links
- Near To Shops
- Recently Updated
- Easy Parking
- Spacious Living

A spacious one bedroom property located in a great location with excellent facilities around including transport links and shopping amenities.

The property consists of a double bedroom with a spacious bright living area and a modern kitchen, benefitting also from being on the fourth floor.

With easy access to the transport links and the hustle and bustle of city living accompanied by the bohemian lifestyle.





**Elham House,
Pembury Road, E5**

Fourth Floor

Approx. 45 Sq. meters (482 Sq. feet)

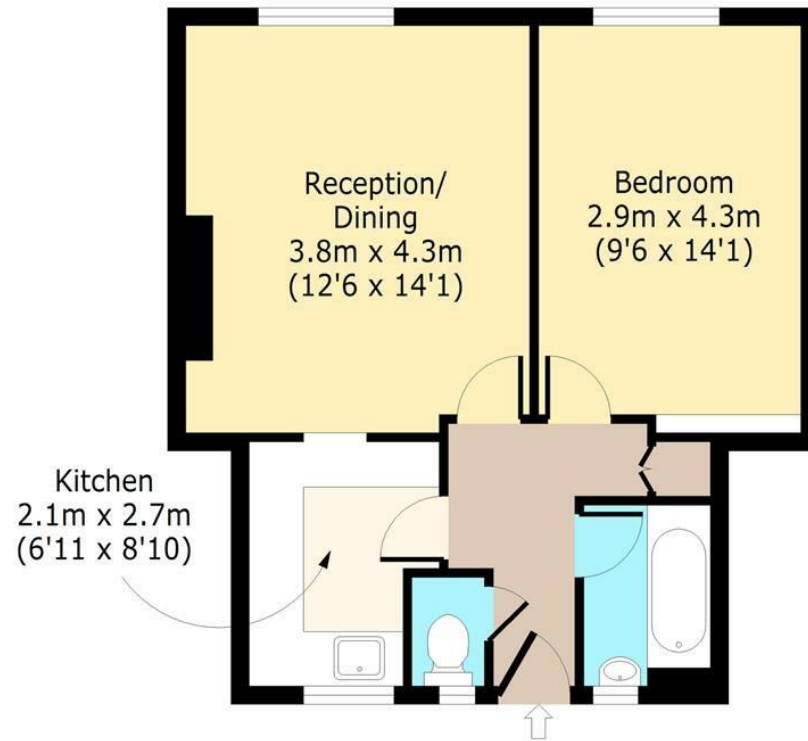

Total area: approx. 45 Sq. meters (482 Sq. feet)
For illustration purposes only - not to scale

IMPORTANT NOTICE - These particulars have been prepared in good faith and they are not intended to constitute part of an offer or contract. We have not performed a structural survey on this property and the services, appliances and specific fittings have not been tested. All photographs, measurements, floor plans and distances referred to are given as a guide and should not be relied upon.

BUTLER & STAG

☎ 020 8102 1236

🏠 508 Roman Road, Bow, London, E3 5LU

✉ bow@butlerandstag.com

www.butlerandstag.uk